

Cable glands & accessories

ALT Tauras™ Cable Glands

Tauras™ BW ALT Range



2 PART INDOOR

Application: Brass indoor gland suitable for all types of steel wire armoured cable (SWA), providing mechanical cable retention and electrical continuity via armour wire termination.

Continuous operating temp: PVC: -20°C to +130°C
LSF: -20°C to +130°C

Ingress protection: IP2X

Approval: BS 6121 Part 1:2005



Complete with award-winning EarthingNut™
INNOVATIVE POWER
PRODUCT OF THE YEAR

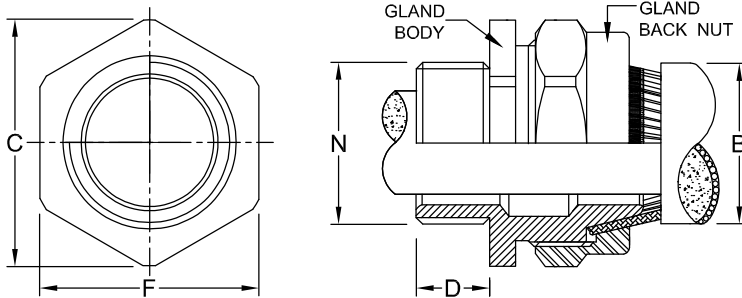

Part No.	Pack Quantity	Entry Thread		Cable Acceptance Details			Hexagonal Details	
		Diameter N	Length D	Diameter B min	Diameter B max	Armour wire size T	A/F F	A/C C
TBW20S* PACK ALT-EN	2	20 x 1.5	10	11.8	15.8	0.90/1.25	22.0	24.4
TBW20* PACK ALT-EN	2	20 x 1.5	10	13.8	19.5	0.90/1.25	25.0	27.7
TBW25* PACK ALT-EN	2	25 x 1.5	10	19.8	27.0	1.25/1.60	33.0	36.6
TBW32* PACK ALT-EN	2	32 x 1.5	10	26.4	33.5	1.60/2.00	40.0	44.4
TBW40* PACK ALT-EN	1	40 x 1.5	15	32.4	40.1	1.60/2.00	48.0	53.3
TBW50S* PACK ALT-EN	1	50 x 1.5	15	37.8	48.0	2.00/2.50	58.0	65.0
TBW50* PACK ALT-EN	1	50 x 1.5	15	44.0	52.6	2.00/2.50	62.5	69.4
TBW63S* PACK ALT-EN	1	63 x 1.5	15	50.5	60.5	2.50	70.0	77.0
TBW63* PACK ALT-EN	1	63 x 1.5	15	56.2	65.5	2.50	76.0	84.4
TBW75S* PACK ALT-EN	1	75 x 1.5	15	62.0	71.6	2.50	85.0	94.4
TBW75* PACK ALT-EN	1	75 x 1.5	15	67.5	78.5	2.50/3.15	90.5	99.0

All dimensions are in mm. *Not included in BS 6121

Pack content: Gland(s), shroud(s), EarthingNut™(s) and crimp terminations.

Packs are also available with Low-smoke LSF shroud.

*Add LSF to the Part No. for Low Smoke & Fume version, i.e. **TBW20SLSF PACK ALT-EN**

To see a video showing a demonstration, scan this QR code

